

DETAIL A  
(N.T.S.)

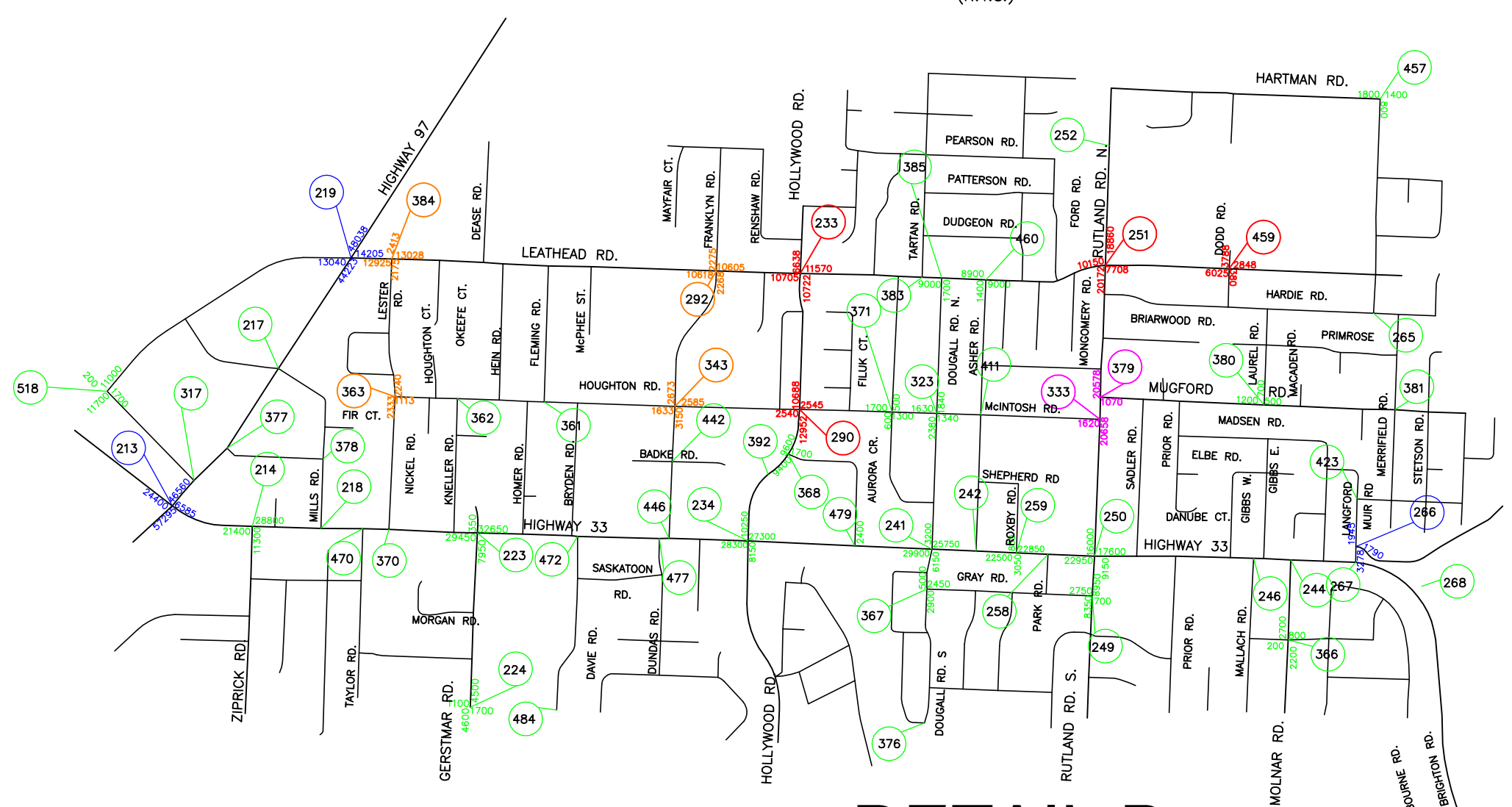

DETAIL B  
(N.T.S.)

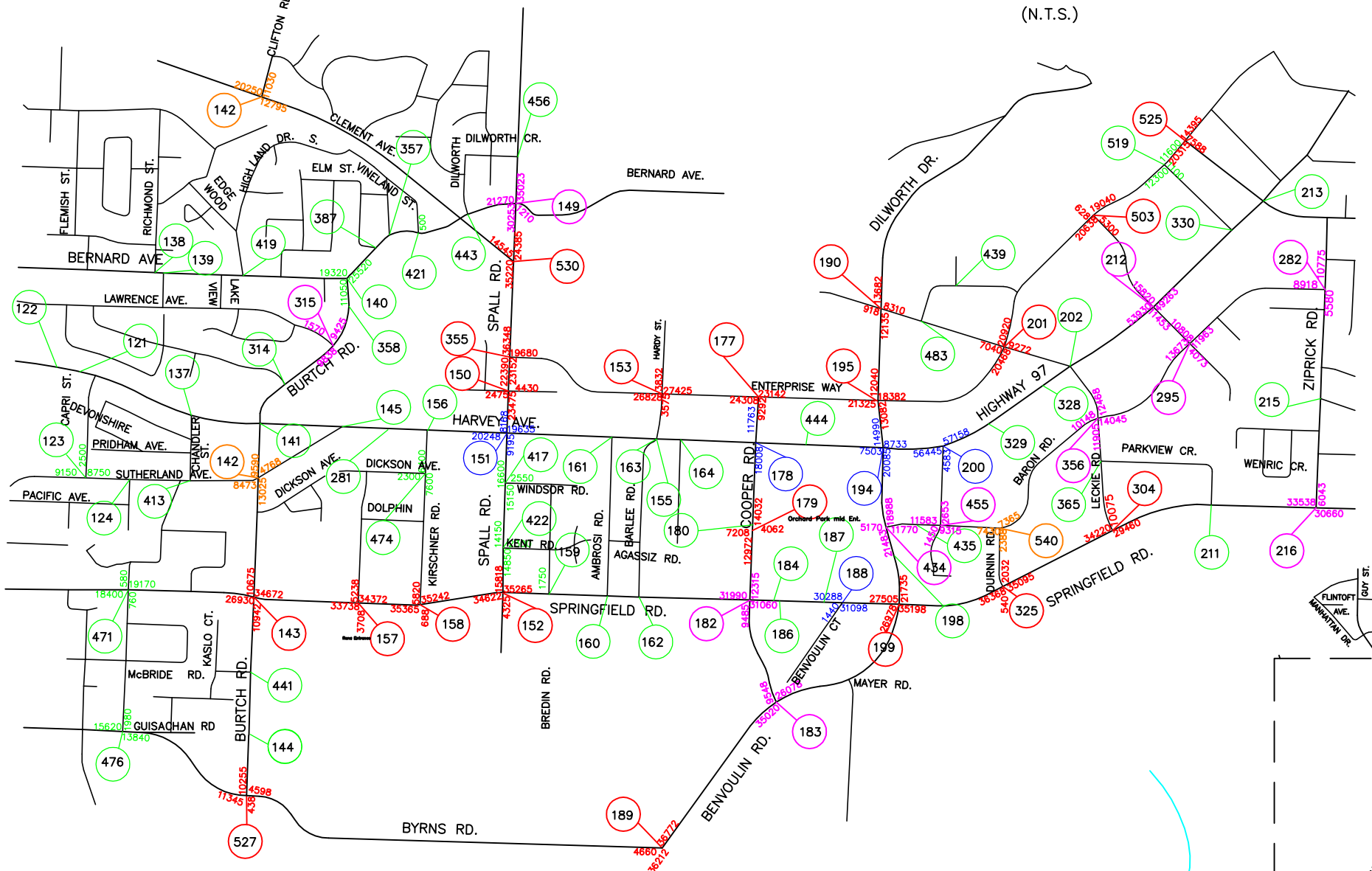

DETAIL C  
(N.T.S.)

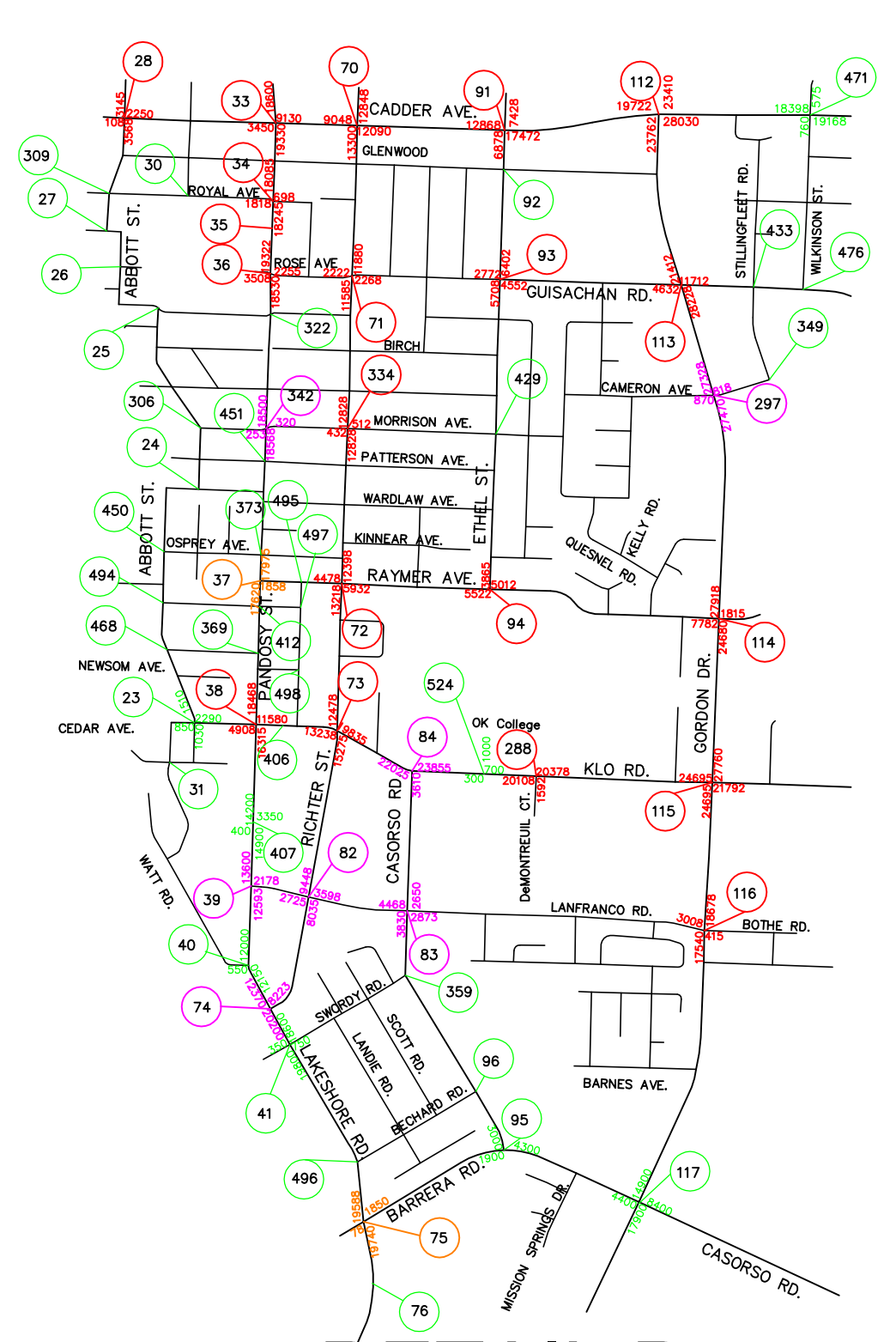

DETAIL D  
(N.T.S.)

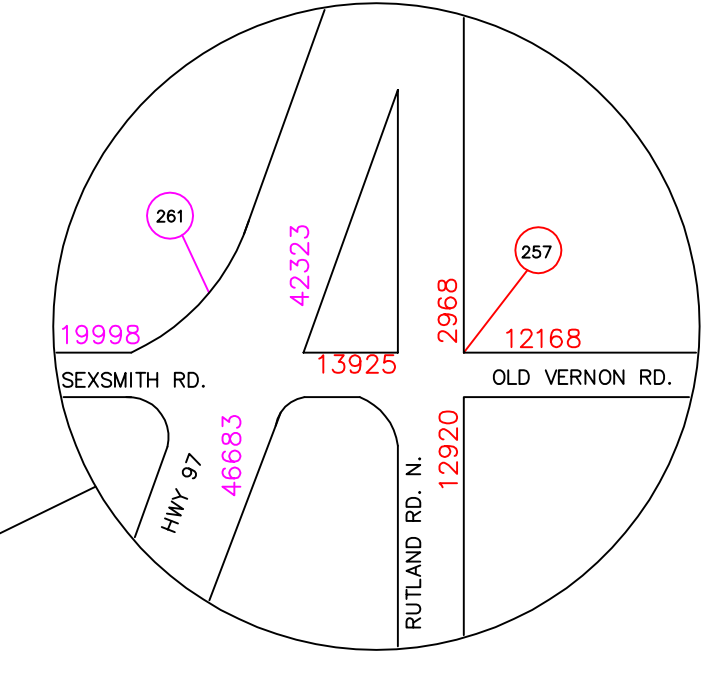
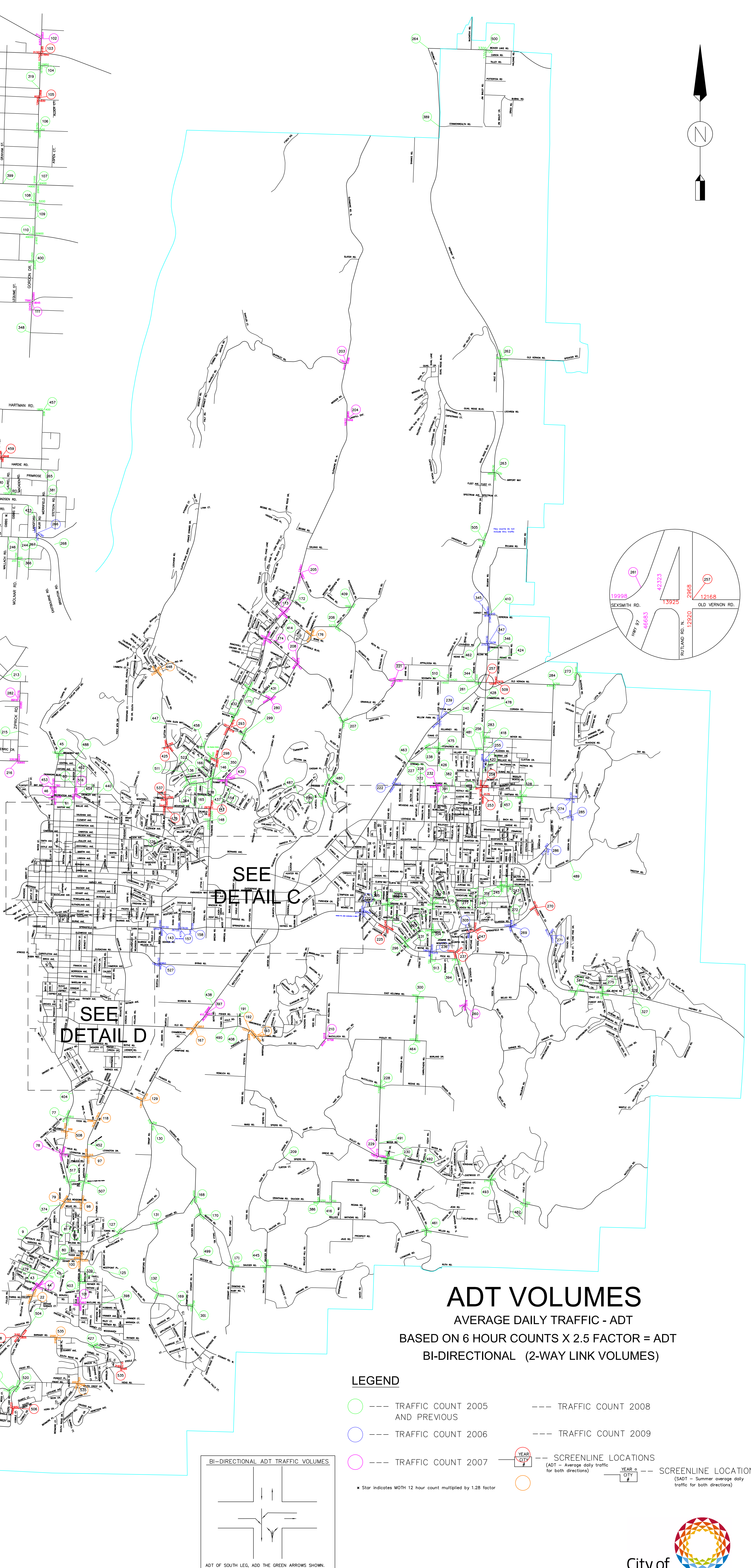

### ADT VOLUMES

AVERAGE DAILY TRAFFIC - ADT  
BASED ON 6 HOUR COUNTS X 2.5 FACTOR = ADT  
BI-DIRECTIONAL (2-WAY LINK VOLUMES)

#### LEGEND

- TRAFFIC COUNT 2005 AND PREVIOUS
- TRAFFIC COUNT 2006
- TRAFFIC COUNT 2007
- TRAFFIC COUNT 2008
- TRAFFIC COUNT 2009
- YEAR  
CITY --- SCREENLINE LOCATIONS  
(ADT = Average daily traffic for both directions)
- YEAR  
CITY --- SCREENLINE LOCATIONS  
(SAOT = Summer average daily traffic for both directions)
- \* Star indicates MOH 12 hour count multiplied by 1.28 factor

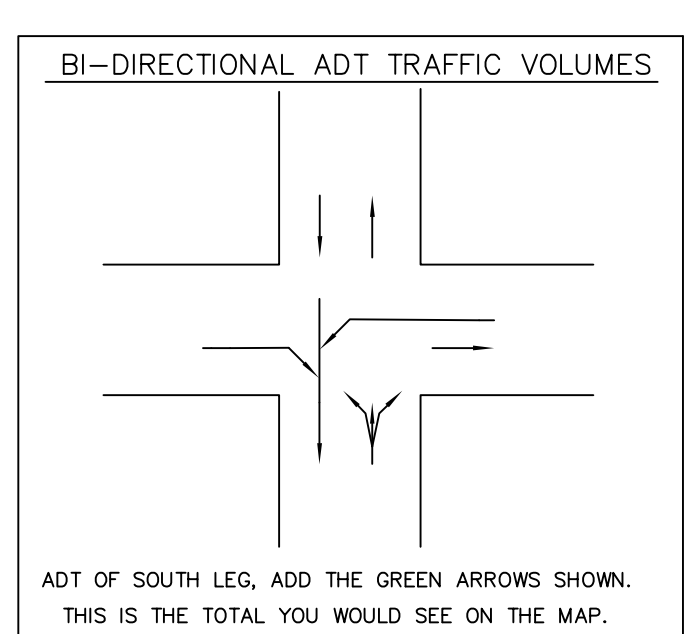

P:\DRAFTING\TRANSPORTATION\2009\VOL\MAP

This map is for general information only. The City of Kelowna does not guarantee its accuracy. All information should be verified.

Revised: JULY 2010

