

Explore unique urban parklets, right on Bernard! Local architects and landscape architects have stepped up for the Parklet Challenge, creating one-of-a-kind parklets (a mini urban park the size of a parking stall) with unique furnishings and features. This year, teams were tasked with designing under the theme of 'Fast Forward/Rewind'. Take a wander through the 400 and 500 block of Bernard Avenue to see what some of our local designers have created!

Parklet 1 Rewind Time

LOCI Landscape Architecture + Urban Design partnered with *Cabin Resource Management Ltd.* and *Elegantly Wooden* to design and build 'Rewind Time', a Parklet inspired by Kelowna's natural landscape, its iconic summer festivities, and most of all... the cassette tapes that revolutionized how they were experienced.

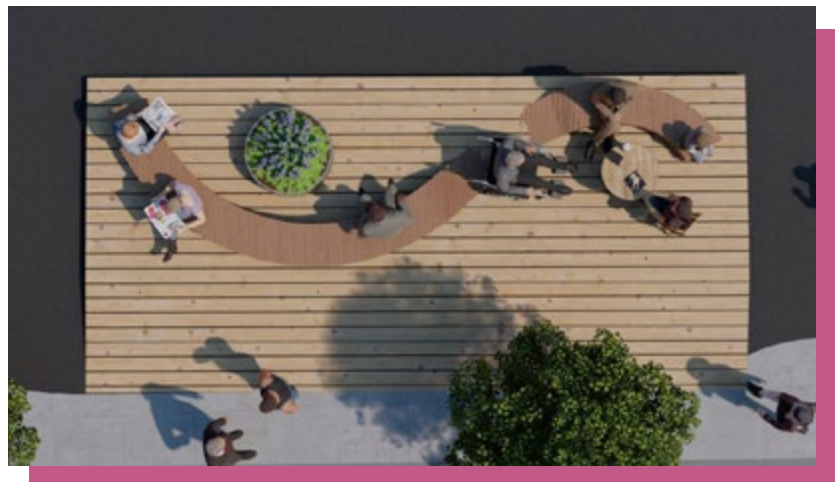

Tasked with the theme of 'fast forward/rewind', two things immediately came to mind: the cassette tape and music as a function of nostalgia. Kelowna's rolling mountains, Okanagan Lake and hot summers, paired with its community spirit produced decades of iconic summer festivities. Music's ability to evoke nostalgia, or 'rewind time' made us think about what songs were playing in the summers of Old Kelowna. Our team was drawn to the cassette's sensory components of fast-forward/rewinding that's uncommon in modern music listening, whereby the user can see and hear the movement of the magnetic tape coated with melodies, gathering from one wheel to the other. This flow of tape between two reels presents a tangible passage of time and finds itself one of the core inspirations of our design.

Parklet 2 CR[E]ATE[A]PARK

Inspiration for the form of our parklet came from the iconic and ubiquitous fruit crate. The fruit crate is an iconic element within the fruit industry. It's simple...it's a plywood box, strong, square, stackable, and red. These red bins have become ingrained in the landscape of the Okanagan and represent the bounty of the agricultural economy. They also are a symbol of changing seasons, waiting at row's end in the orchards to be filled in the fall, or piled high in the winter months in stockpiles reminiscent of building towers. Our parklet has put a modern spin on the crates and its modular form allows us to reconfigure the pieces to form different experiences for the user. The tree rounds are a subtle nod to the orchards that once stretched all the way down to the lake. We'd like to thank our sponsors BC Tree Fruits, Cloverdale Paint and Synthetic Turf international for their part in making our CR[E]ATE[A] PARK happen. Great community partners make for a great community!



Design concept of CR[E]ATE[A]PARK by WSP. The design uses modular units to create a variety of lounging arrangements. The 'apples' further link to the agricultural culture of the Okanagan.

Parklet 3 Upcycle

Kelowna has a rich history of transportation that has evolved with the city over time. From railways, to roads, to public and active transportation infrastructure, Kelowna is an example of how our methods and patterns of movement have and continue to change. The focus on recycled and upcycled materials is reflective of Urban Systems' commitment to improving active transportation and green infrastructure in the spirit of serving vibrant communities. The design of Upcycle showcases this journey and evolution using recycled vehicle tires and bicycle wheels, upcycled woven bicycle tubes and trestle-inspired site furnishings. Our inter-disciplinary team was made up of a variety of disciplines including everything from Landscape Architecture through to Graphic Design.

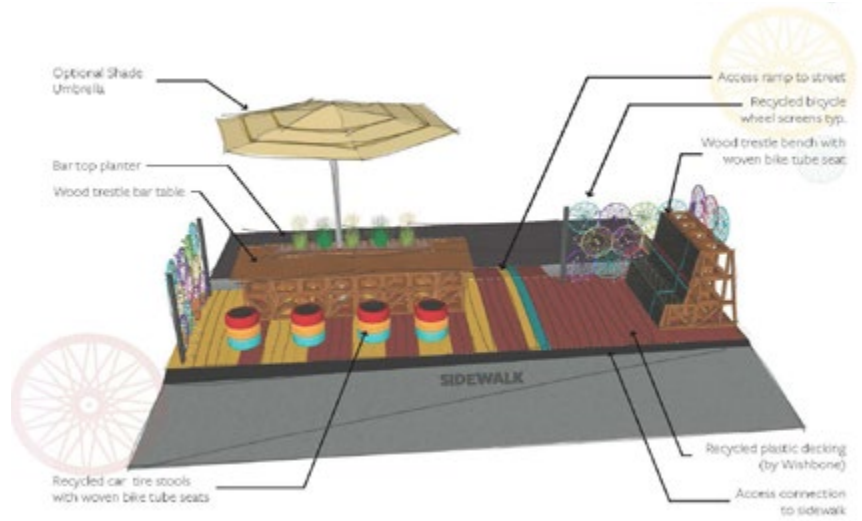

"We know that placemaking can help create a sense of belonging because it provides an opportunity to connect and build relationships in their community. Upcycle is a space for people to meet up with a friend, strike up a conversation with a stranger, sit and enjoy a coffee outdoors, and explore all the amenities Bernard Avenue has to offer."
- **Urban Systems**, creator of Upcycle, along with **Wishbone Site Furnishings**.



*Dock Party was created by **PWL Partnership & Okanagan Yard Works**. "Our design elements aim to reimagine materiality and encourage blissful thoughts of summers past, spent lounging by the lake. It certainly does for us!"*

Parklet 4 Dock Party

Dock Party is a whimsical interpretation of Kelowna and the Okanagan's natural features, alongside celebrations of summertime lake lifestyles. The parklet aims to scale down the natural features of the Okanagan landscape, featuring a mini-Interior Plateau that doubles as a seating step capped by native vegetation donated by the Okanagan Xeriscape Society and Wild Bloom Nursery. Artificial turf, donated by SynLawn, represents Okanagan Lake and the surrounding vineyards. These features are brought to life with an imaginative dock structure evoking a user's sense of relaxation by the lake on hot summer days. Two brightly painted beach tubes illustrate youthful joy and play, awakening memories of water play activities. The pallets used to construct the dock structure were generously donated by Valley Pallet Inc. while the beach tubes are repurposed tractor tires.

Parklet 5 Time to Rise

"Time to Rise" is a positive message, inspired by the city's very name, inviting residents to come out of hibernation after over a year and a half of experiencing the isolation and uncertainty of the pandemic. The design consists of multiple grizzly bears, also known as 'Kelowna' in the original Okanagan/Syilx First Nation language, positioned in different standing postures. Each bear has a person-shaped cutout in the middle, providing opportunities for visitors to interact with the bears in whimsical ways. By walking through them or by mimicking the bear's standing posture, our intent is to let visitors have fun with the design and maybe even realize that it is "Time to Rise" out of our collective hibernation.

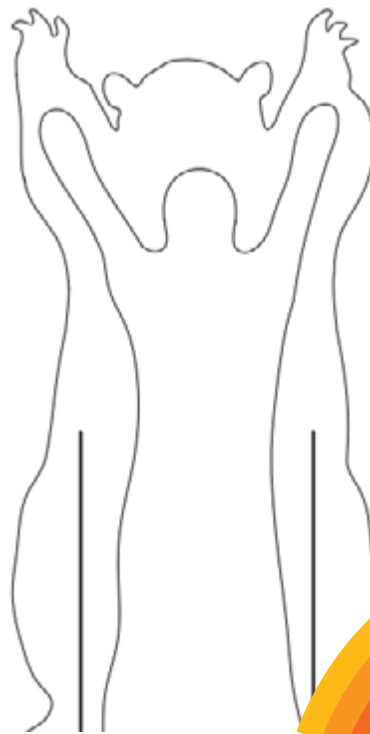

PMG Landscape Architects Ltd. is behind the concept of 'Time to Rise' and believes that great design makes the world a more wonderful place.

"We understand how important outdoor spaces have become in allowing people to remain connected as the pandemic has progressed. By creating a whimsical, thoughtful parklet intervention, we hope to help the local community re-connect with the people and places in their City, and to recover from the effects of the isolation resulting from COVID-19."

Parklet 6 The Zippenzee

The Zippenzee (Sip and See) brings urban and rural dimensions together in the microcosm of a parking stall in Downtown Kelowna. The parking stall transformed into the parklet becomes a place for comfortably lounging, people-watching, eating and drinking along the backdrop of Kelowna's main street, while doubling as a small source of urban farming and food production in urban context.



The Zippenzee concept by **Outland Design Landscape Architecture** with support from **Wishbone Site Furnishings**, created with sustainable, recyclable or reusable materials.

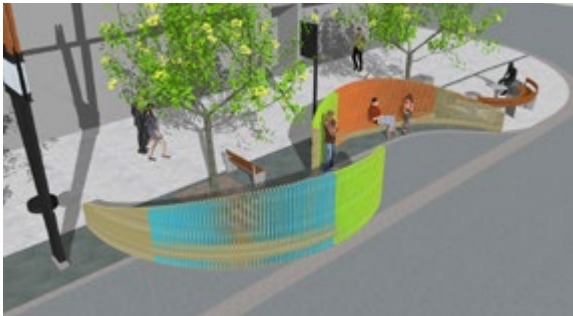

Parklet 7 The Resurgence

The Resurgence project team goal is to provide the citizens of Kelowna with a place of comfort, interest, and quality while addressing and respecting the challenges of the site. The parklet has been named "Resurgence" to symbolize the community's resurgence and renewal after the COVID-19 pandemic. The project team sees design and construction of the parklet as an excellent opportunity to give back to the community that has made them successful.

The Resurgence is a collaboration between **Thinkspace Architecture® Planning Interior Design** and **West Bay Construction**. The undulating shape reflects the many aspects of our lives that went down and came back up again during this challenging time.

Look for these featured parklets on the 400 and 500 blocks of Bernard Avenue this summer.

Interested in learning more about the Parklet Challenge?

Contact Melanie Steppuhn, Parks & Building Services, City of Kelowna
msteppuhn@kelowna.ca

