

4-hour Evening Counts on Ellis & Water, July '99. Retain previous 6-hour ADT volumes.

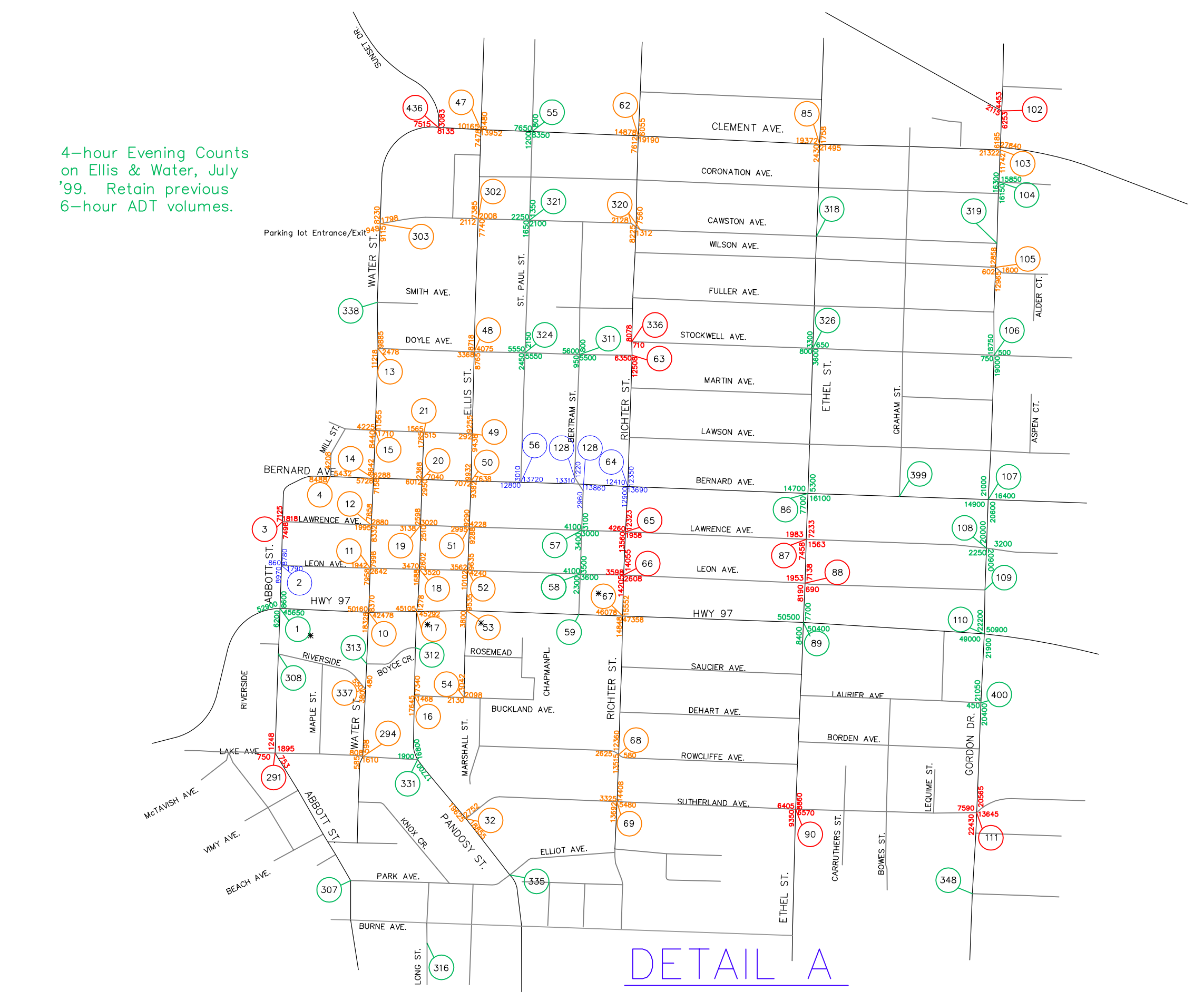

DETAIL A
(N.T.S.)

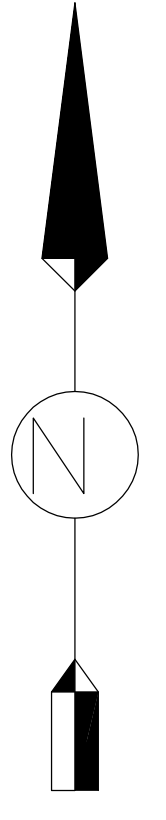
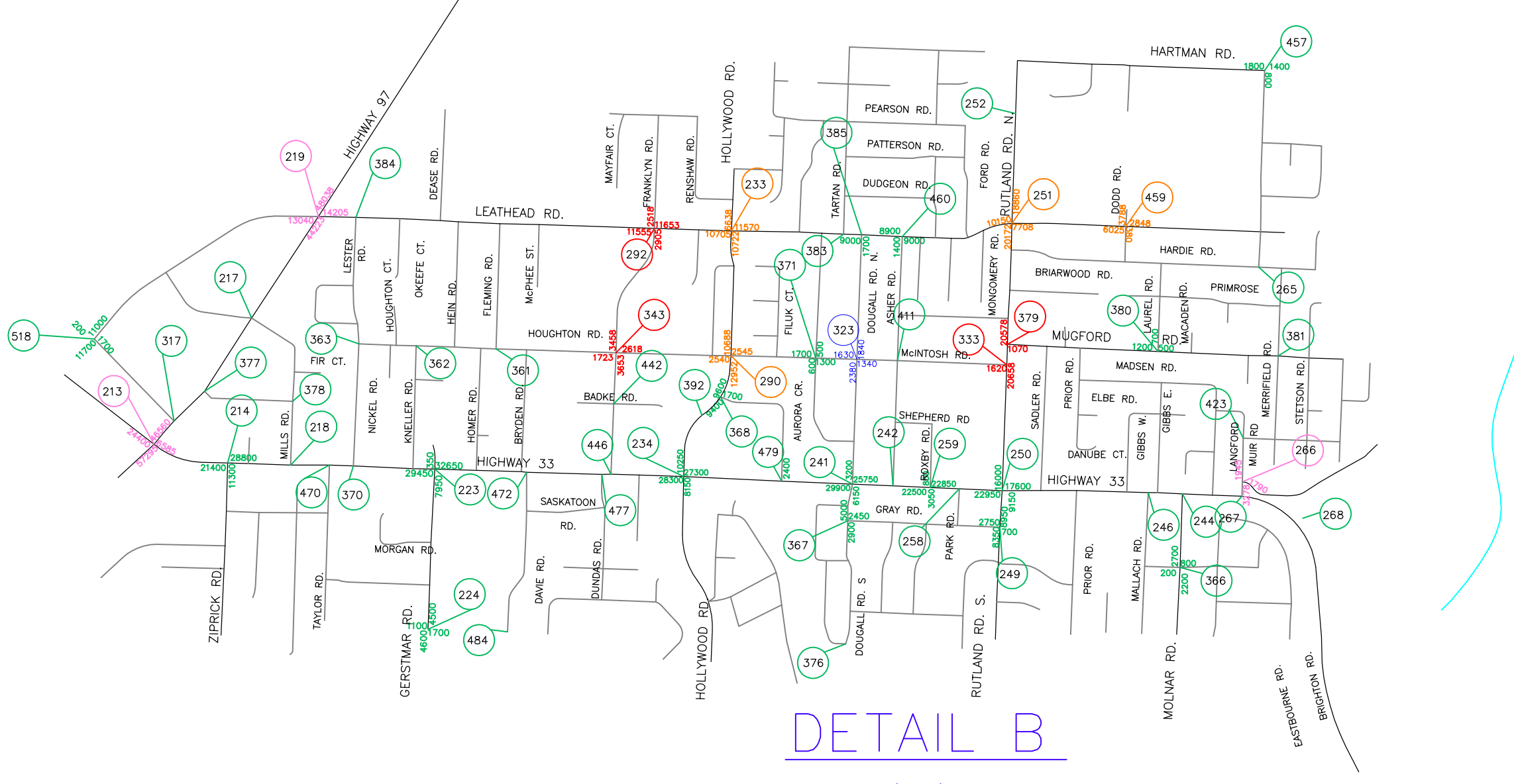

DETAIL B
(N.T.S.)

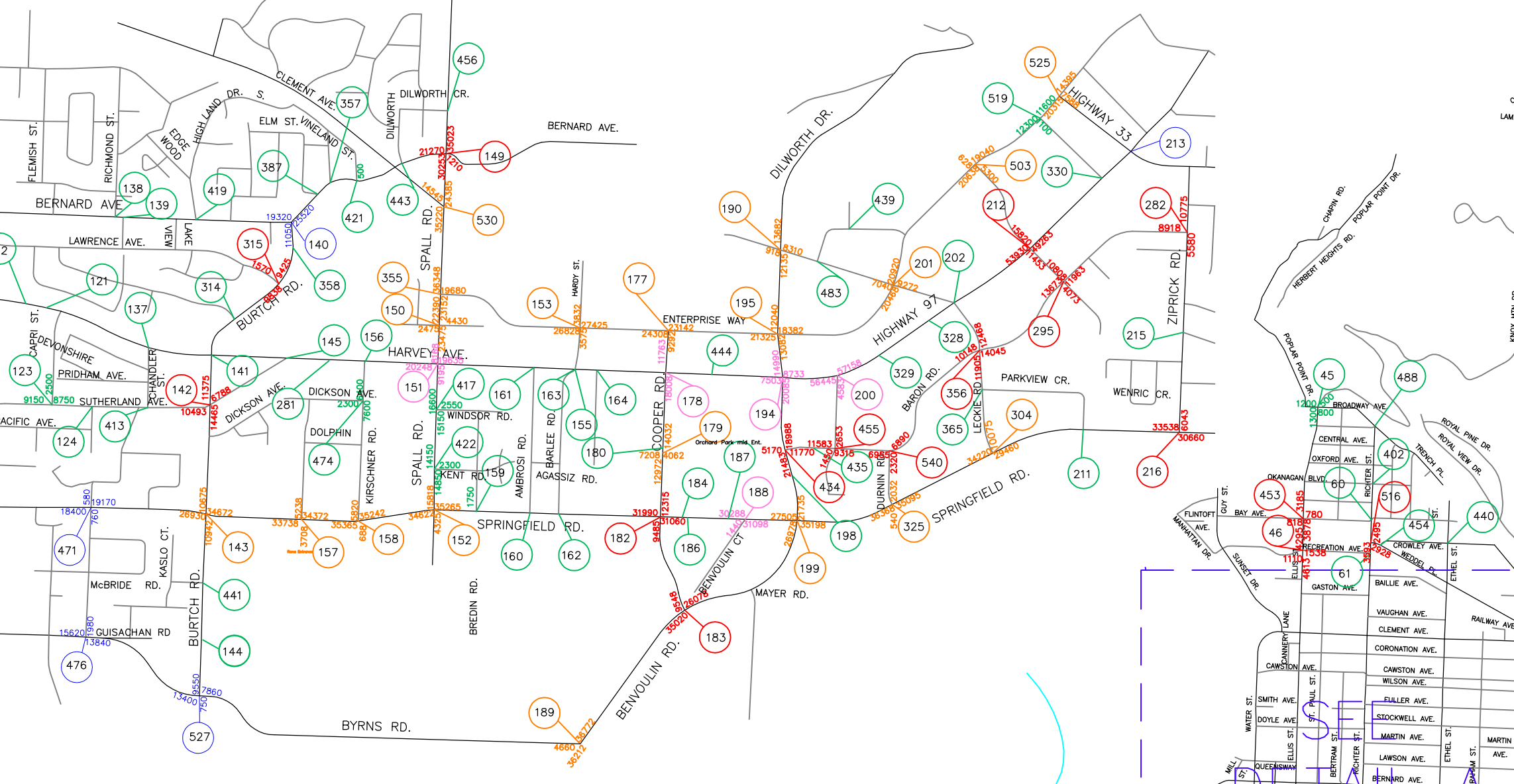

DETAIL C
(N.T.S.)

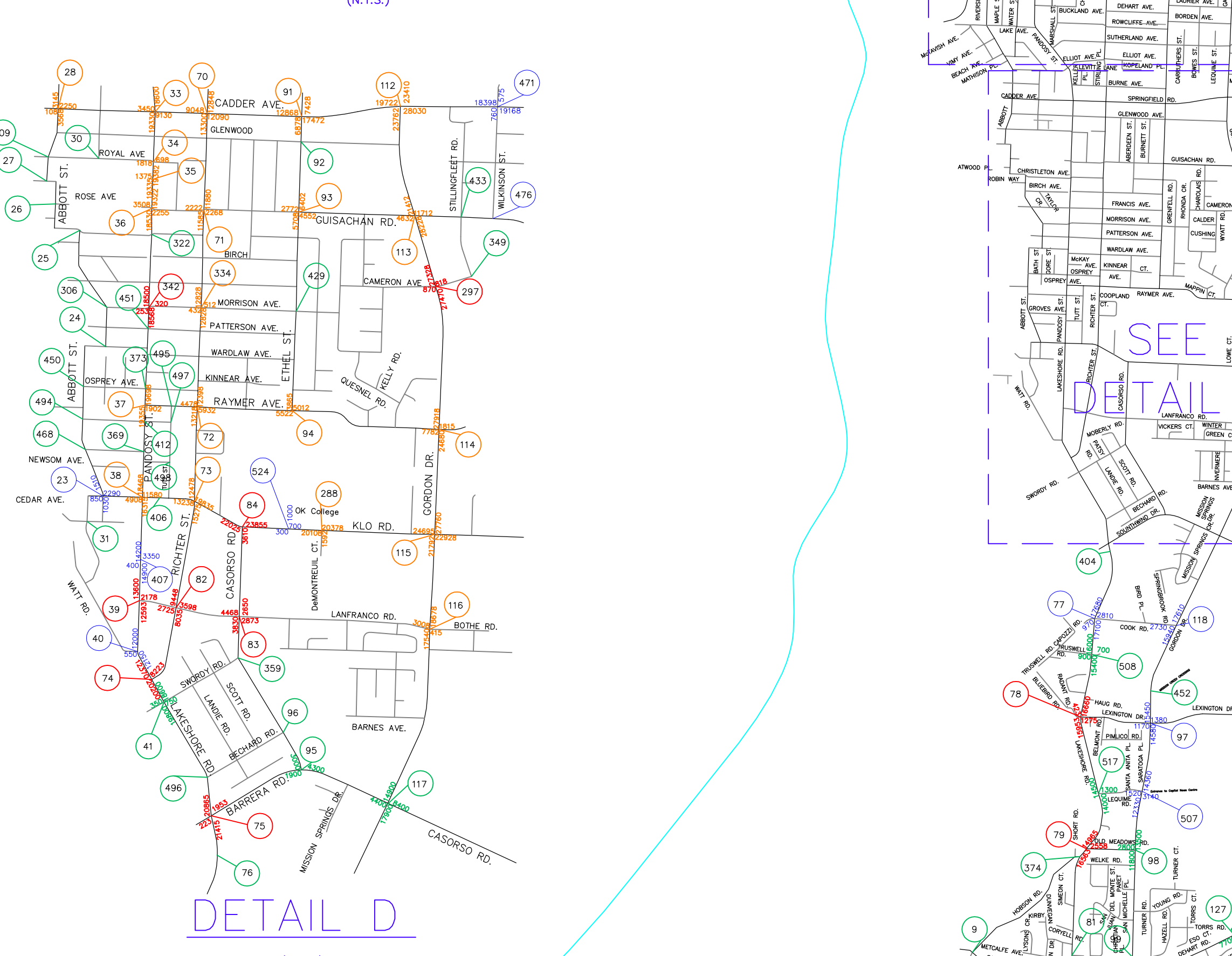

DETAIL D
(N.T.S.)

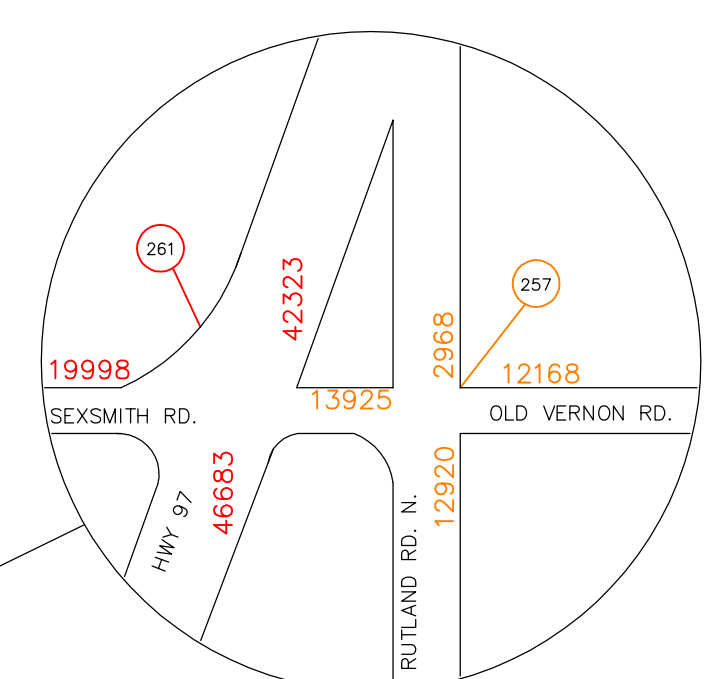
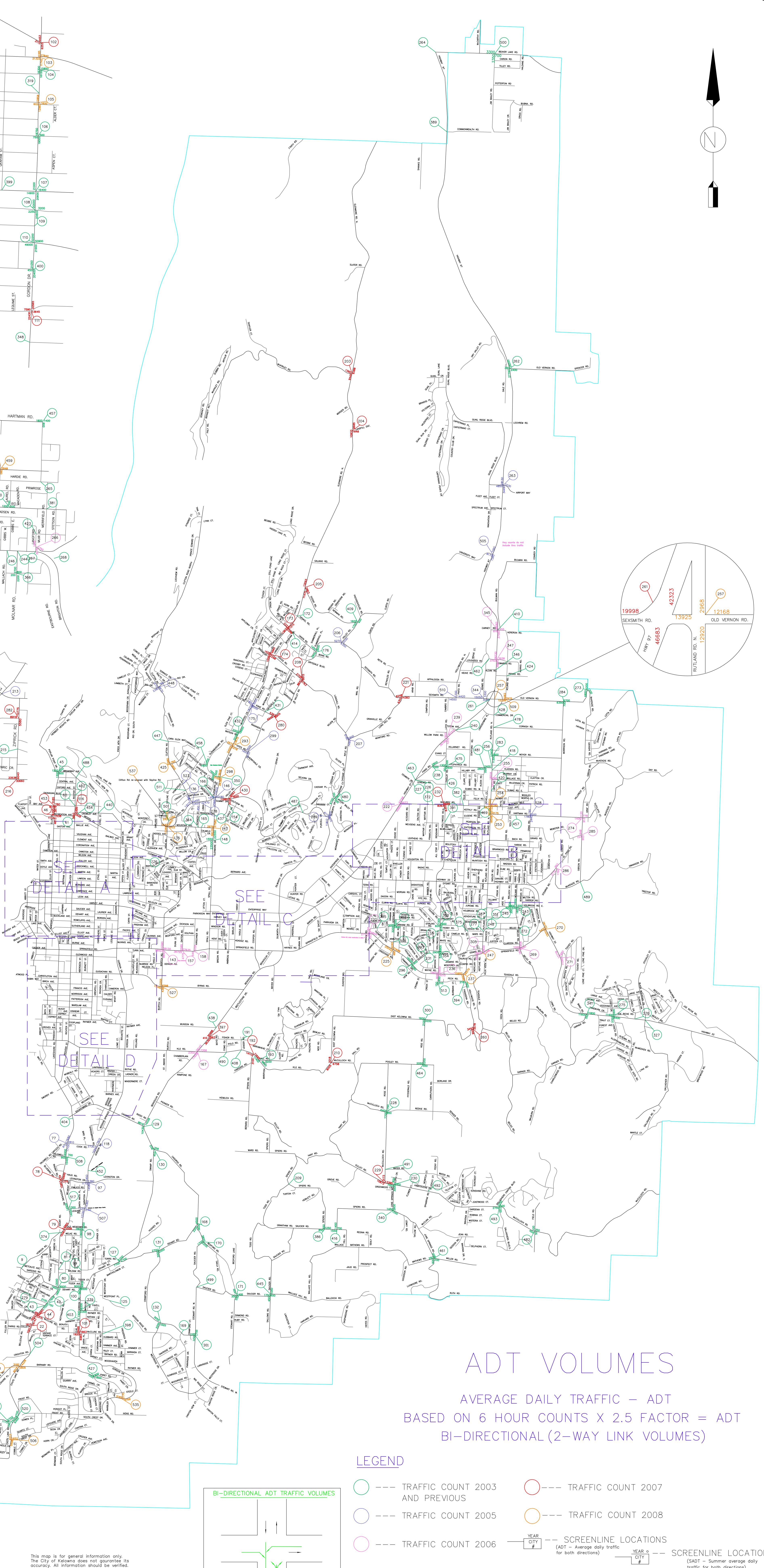

ADT VOLUMES

AVERAGE DAILY TRAFFIC - ADT
 BASED ON 6 HOUR COUNTS X 2.5 FACTOR = ADT
 BI-DIRECTIONAL (2-WAY LINK VOLUMES)

LEGEND

- --- TRAFFIC COUNT 2003 AND PREVIOUS
 - --- TRAFFIC COUNT 2005
 - --- TRAFFIC COUNT 2006
 - --- TRAFFIC COUNT 2007
 - --- TRAFFIC COUNT 2008
 - SCREENLINE LOCATIONS (ADT - Average daily traffic for both directions)
 - SCREENLINE LOCATIONS (SADT - Summer average daily traffic for both directions)
- * Star indicates MOTh 12 hour count multiplied by 1.28 factor

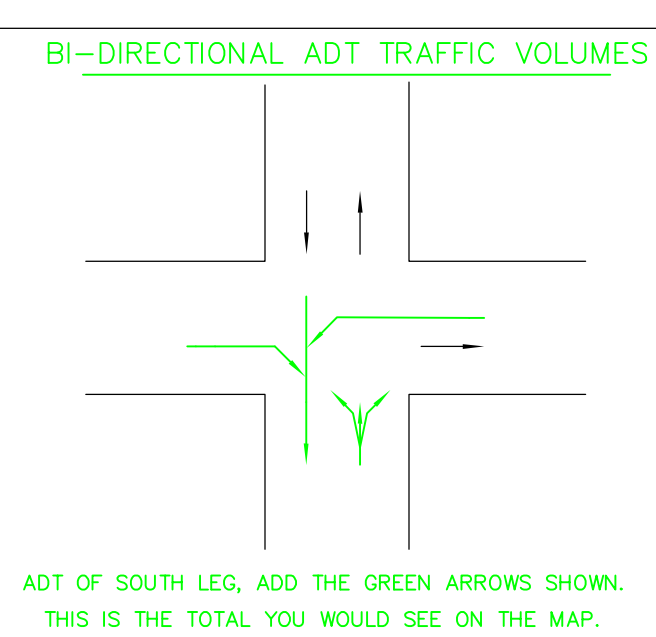

This map is for general information only. The City of Kelowna does not guarantee its accuracy. All information should be verified.

CITY OF KELOWNA
 WORKS AND UTILITIES